

LIGHTWAY 6 - WALL RECESSED

Product Installation Guide

WARNING:
THE SAFETY OF THIS FIXTURE IS GUARANTEED ONLY WHEN COMPLYING WITH THE FOLLOWING INSTRUCTIONS

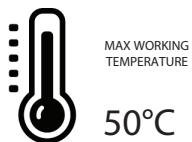
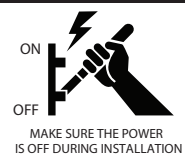

Electrical cables

Profile

Housing

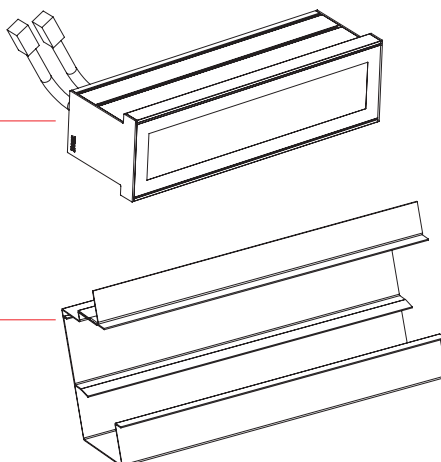

FOLLOW THE BELOW STEPS TO INSURE A PROPER INSTALLATION

STEP 1: Prepare a hole for the luminaire with the precise dimensions.

Applicable surfaces :

Concrete

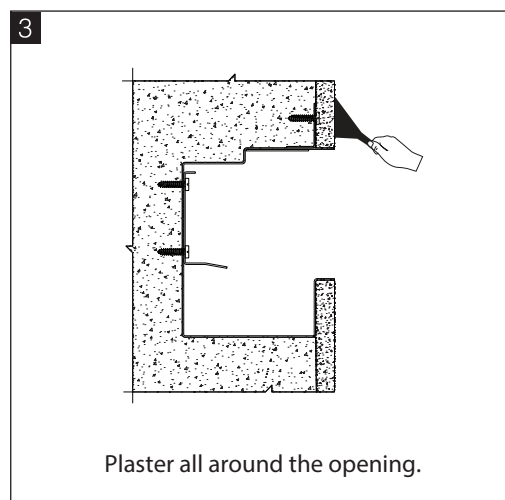
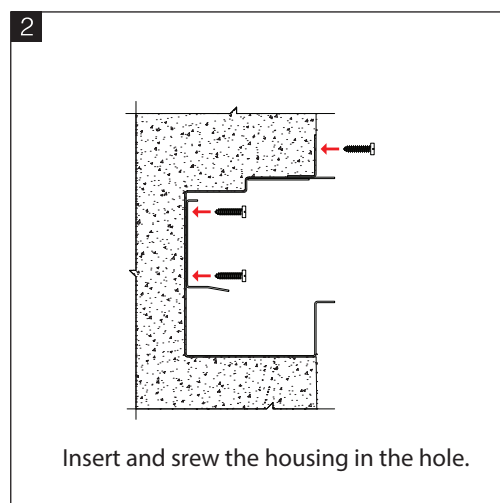
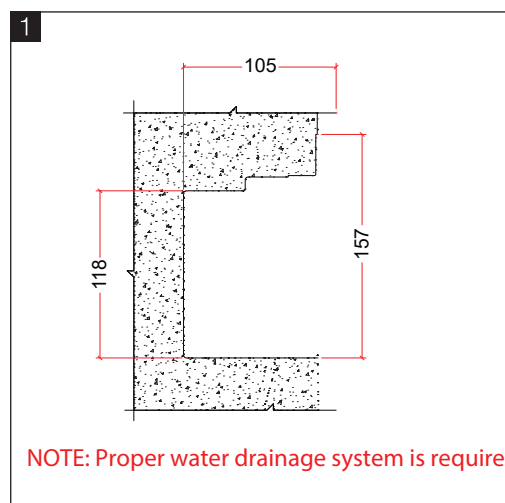

LIGHTWAY 6 - WALL RECESSED

Product Installation Guide

REFER TO THE TABLE FOR TYPICAL INSTALLATION PARAMETERS

Optic type	Distance between wall and fitting
Grazing	Between 10cm and 15cm (4" and 6") Depending on the wall texture
Washing	Between 1/5 and 1/6 of the wall height to be washed.
Other	Depending on the desired effect.

NOTE:

- 1 - Always wear cotton gloves to avoid fingerprints mark on the product.
- 2 - Make sure to place all dismantled items in a safe and clean area to avoid any possible damage.
- 3 - LED should be protected from any possible electrostatic discharge (ESD) source.

STEP 2: Insert the luminaire electrical cable into the relative electrical tube and make the required connections (L + N + EARTH)

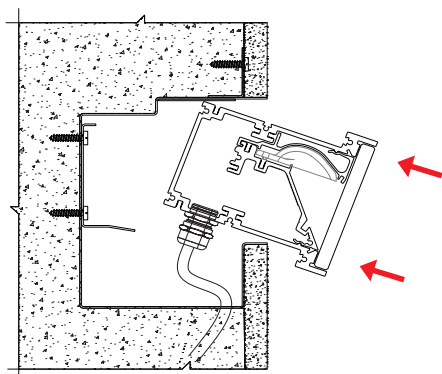

STEP 3: Clip-in the luminaire into the housing.

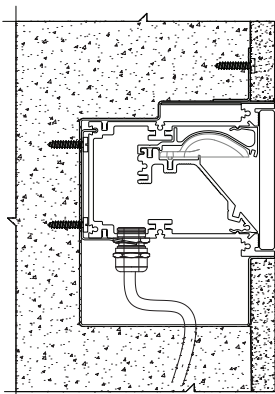

* Make sure not to exceed the maximum allowable running length according to the below table:

Maximum running length through 1 feeding input												
System	Voltage	Power										
		L1 10 W/m	L2 15 W/m	L3 22 W/m	L4 30 W/m	L5 42 W/m	P1 20 W/m	P2 30 W/m	P3 42 W/m	M1 28 W/m	M2 40 W/m	M3 56 W/m
UL	120V~ 60 Hz	135 ft	100 ft	70 ft	50 ft	36 ft	70 ft	50 ft	36 ft	54 ft	38 ft	27 ft
CE	220-240V~ 50/60 Hz	62 m	45 m	33 m	23 m	17 m	33 m	23 m	17 m	25 m	18 m	13 m

WARNING :

- THE FEEDING VOLTAGE SHOULD NOT EXCEED THE SPECIFIED FIXTURE VOLTAGE.
- DO NOT INSTALL THE FIXTURE IF DAMAGED
- UNAUTHORIZED REPAIRS OR MODIFICATIONS WILL VOID WARRANTY