

ZINC UNO

Product Installation guide

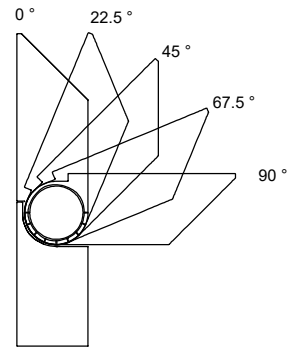

(For remote driver items)

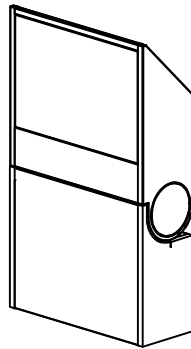

RISK OF FIRE AND ELECTRICAL SHOCK



1. Turn off the electrical power before starting the installation of the light fixture.
2. The feeding voltage must not exceed the specified fixture voltage.
3. This product must be installed by an eligible electrician.
4. Make sure the luminaire is mounted to a secure structure. Failure to mount the fixture correctly could result in serious injury.
5. The luminaire with 120 V AC input must be earthed in a reliable way.
6. The light source of this luminaire is not replaceable; when the light source reaches its end of life the whole luminaire shall be replaced.
7. Wear gloves and safety glasses at all times, moreover when removing the luminaire from the box, installing, servicing and performing its maintenance.
8. It is very important not to install a damaged product! This luminaire is properly packed to avoid being damaged during transit. Check for impaired objects before installation. Any damaged or broken item during or after assembly must be replaced.
9. Unauthorized repairs or modifications will void warranty.

A-Surface Mounted

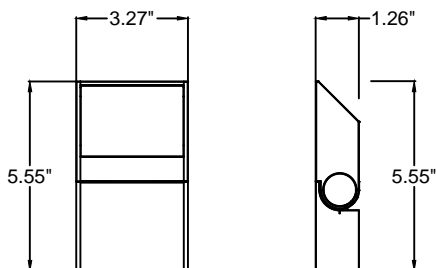

Dimensions in mm.

B-Spike Mounted

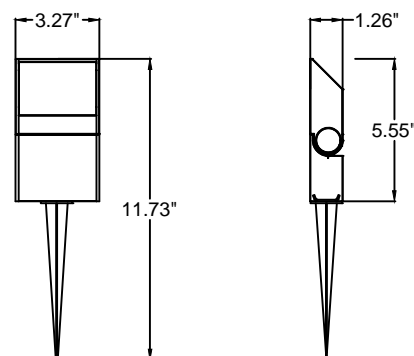

Dimensions in mm.

ZINC UNO

Product Installation guide

Hidden Feeding

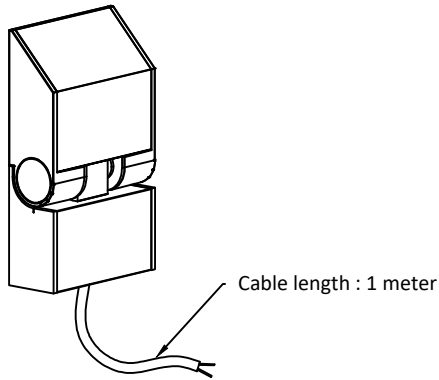

Built in Driver: 3 Pole Cables (Line, Neutral, Ground)
Remote Driver: 2 Pole Cables (LED+, LED-)

Back Feeding

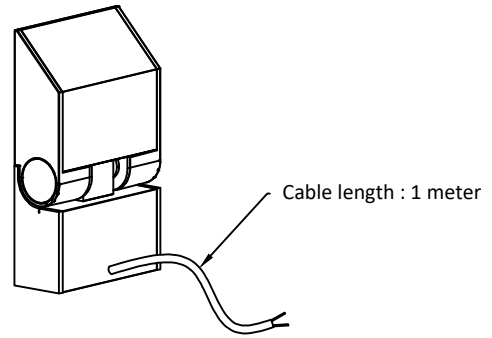

Built in Driver : Cable 3 Poles (Line, Neutral, Ground)
Remote Driver : Cable 2 Poles (LED+, LED-)

Wiring for Built in Driver (Non Dimmable)

Fixtures with Built in driver types (Class 1), the 3 Pole cable has to be connected to the mains voltage (120V~ 60 Hz)

Color Code :

- Line : Black
- Neutral : White
- Ground : Green

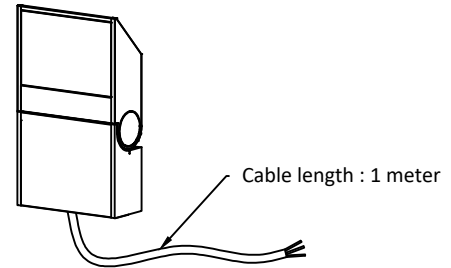

Wiring for Remote Driver (DALI or 1-10V)

One driver is suitable to energize from 1 to 4 luminaires

Fixtures with remote driver type the connection has to be in series as the wiring below diagram show :

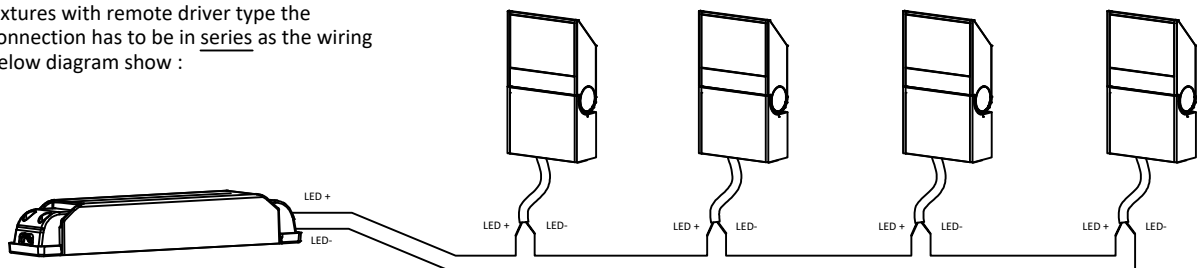

 The driver is IP20 and has to be placed in a safe and dry location